



5/28 Homedale Crescent Connells Point NSW

 3  2  2

Unique Private Townhouse with Private Inground Pool

Spacious living room with separate dining area
 Modern open plan kitchen with stainless steel appliances and breakfast bar
 Three bedrooms with built-in robes in all
 Complete bathroom with separate bath and shower
 Ensuite bathroom to main bedroom
 Internal laundry shower and toilet plus direct access to rear yard
 Double remote operated garage with internal access
 Private sparkling in-ground pool with entertaining area
 Additional entertaining deck with electric vergola
 Rumpus room or 4th bedroom leading to pool area
 Direct access to public playground and park
 Ducted air-conditioning
 Quiet well maintained complex of only 6 villas

To arrange an inspection please contact the team at Brookes Partners on 95468666 or 0411 380010

Type : Townhouse
Date Available : Wednesday, 9th October 2019
Bond : 3,000
View : <https://www.brookes.net.au/lease/nsw/st-george/connells-point/residential/townhouse/5757568>

Jodie Heeks
 m: 0413 447 299
 o: 9546 8666
 e: jh@brookes.net.au

Alexander Lapinski
 m: 0411 380 010
 o: 9546 8666
 e: al@brookes.net.au



FIRST FLOOR

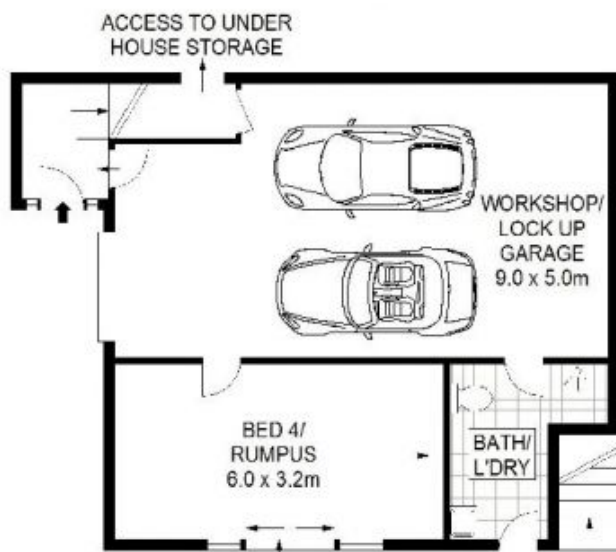

GROUND FLOOR



SITE PLAN
(NOT TO SCALE)

ADDRESS :

5/28 Homedale Crescent, CONNELLS POINT

DISCLAIMER: THIS IS FOR ILLUSTRATIVE PURPOSES ONLY. ALL DIMENSIONS ARE APPROXIMATE AND IT DOES NOT CONSTITUTE PART OF ANY LEGAL DOCUMENTS.

0 1 2 3 4 5